

AccuPoint[®] Advanced Next Gen

AccuPoint Advanced Sanitation Verification System
is accurate in detecting ATP.

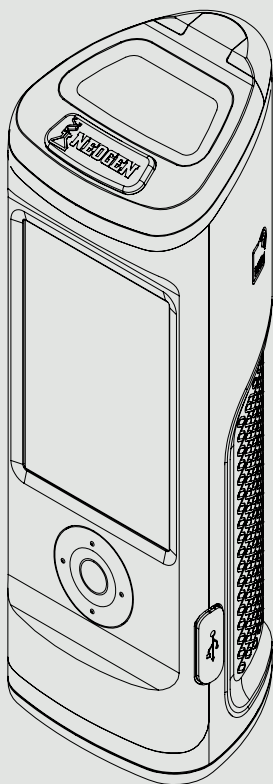

01. To power on the reader, press and hold the center button on your AccuPoint Advanced Next Gen. Enter user name and password if required.

02. Select Standard Test (when using a site plan) or Quick Test for general sampling. Under standard testing, select the correct site to be tested.

03. Sample your site by “drawing” a 4” x 4” square. With a vertical and horizontal back-and-forth motion “fill” in the square. Consistency is critical.

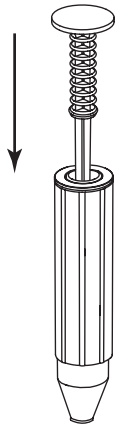
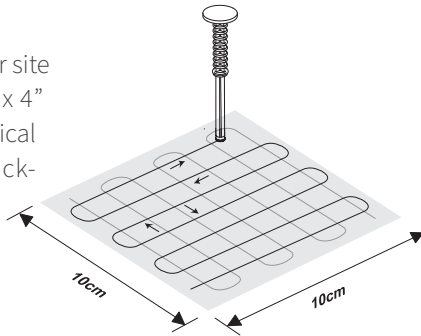

04. Hold the sampler vertically and fully depress to activate.
Note: the sampler must be held vertically.

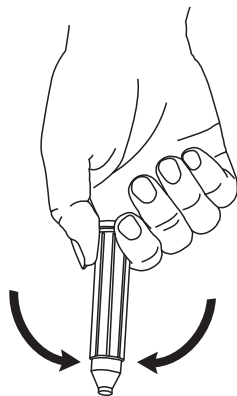

05. Mix gently for two seconds.
NOTE: do not shake.

06. With the instrument held upright, press the eject button and insert the sampler.

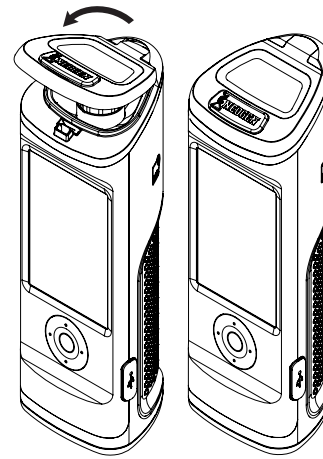
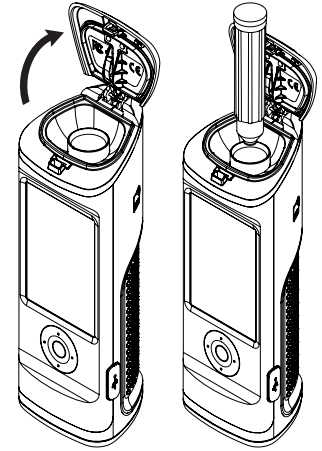

07. Depress the sampler all the way down and close the door.
Note: keep instrument upright while the sample is being read.

08. The RLU score will display along with a symbol for pass, marginal or fail.

09. On the results screen, users have the option to enter notes for that result, retest that site, or move to the next site in their plan.

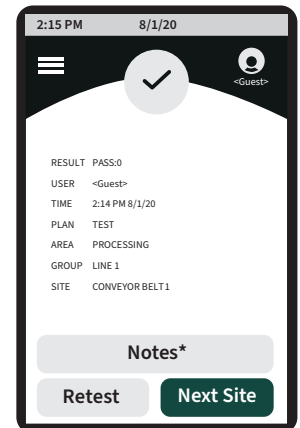

Water Sample

01. Turn the instrument on. Make sure it's at the main screen.

02. Select the correct site to be tested. A water droplet icon on the display indicates to use a water sampler.

03. Take your sample by dipping the water sampler into the liquid.

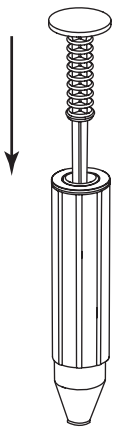
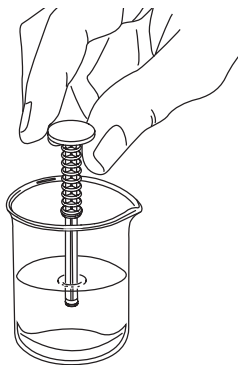

04. Hold the sampler vertically and fully depress to activate.

Note: The sampler must be held vertically

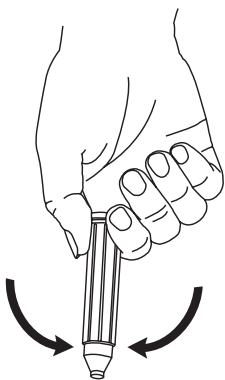

05. Mix for two seconds.

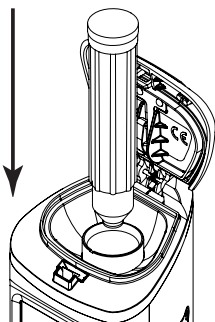

06. Place in instrument immediately

Access Sample

01. Turn the instrument on. Make sure it's at the main screen.

02. Select the correct site to be tested.

03. Remove the Access sampler and take your sample.

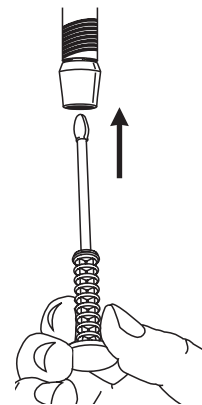

04. Hold the sampler vertically and fully depress to activate.

Note: The sampler must be held vertically

05. Mix for two seconds.

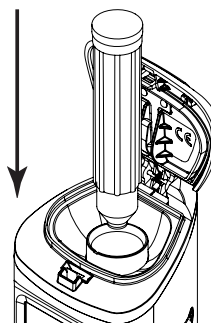

06. Place in instrument immediately

01. Presione y mantenga presionado el botón central en su AccuPoint Advanced Next Gen. Introduzca un nombre de usuario y contraseña si lo desea.

02. Seleccione Prueba estándar (cuando utilice un plan de sitio) o Prueba rápida de muestreo general. En las pruebas estándar, seleccione el sitio correcto que se va a analizar

03. Obtenga la muestra del sitio “trazando” un cuadrado de 10 cm x 10 cm. “Llene” el cuadrado mediante un movimiento vertical y horizontal hacia adelante y hacia atrás. La uniformidad es crítica.

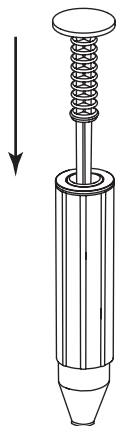
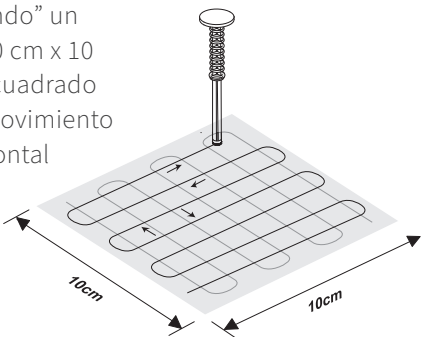

04. Sostenga el muestreador de manera vertical y oprima hasta el fondo para activarlo. *Nota: el muestreador se debe sostener de manera vertical.*

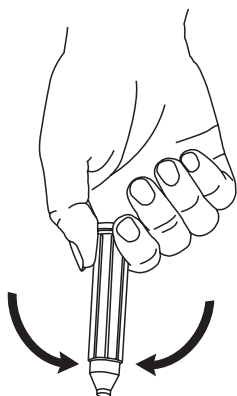

05. Mezcle suavemente durante dos segundos. *NOTA: No agite*

06. Sosteniendo el instrumento en posición vertical, presione el botón de expulsión e inserte el muestreador.

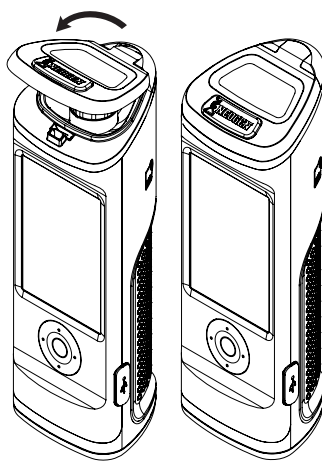
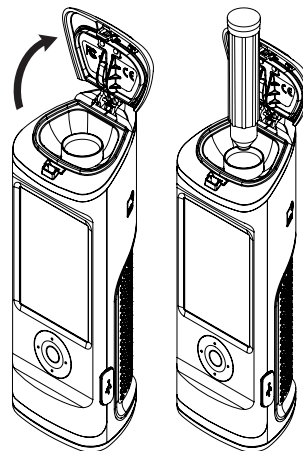

07. Oprima el muestreador hasta el fondo y cierre la puerta. *Nota: sostenga el instrumento en posición vertical mientras se lee la muestra.*

08. La puntuación en unidades RLU se mostrará junto con un símbolo de aprobado, marginal o no aprobado.

09. En la pantalla de resultados, los usuarios tienen la opción de introducir notas para dicho resultado, volver a analizar ese sitio o pasar al siguiente sitio del plan.

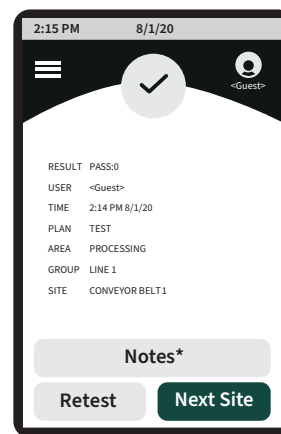

Muestreador de agua

01. Encienda el instrumento. Asegúrese de que esté en la pantalla principal.

02. Seleccione el sitio exacto que se va a analizar. Un ícono de gota de agua en la pantalla indica que se debe utilizar un muestreador de agua.

03. Tome la muestra sumergiendo el muestreador de agua en el líquido.

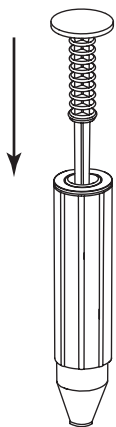
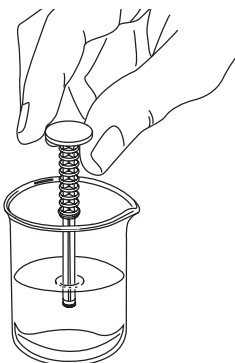

04. Sostenga el muestreador en posición vertical y oprima hasta el fondo para activarlo.

Nota: el muestreador se debe sostener en posición vertical.

05. Mezcle durante dos segundos.

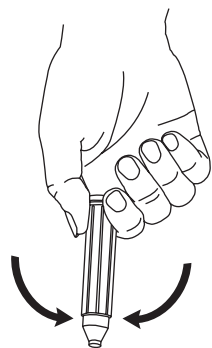
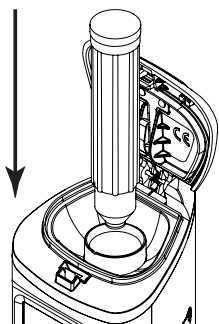

06. Coloque en el instrumento de inmediato.

Muestreador de acceso

01. Encienda el instrumento. Asegúrese de que esté en la pantalla principal.

02. Seleccione el sitio exacto que se va a analizar.

03. Retire el muestreador de acceso y tome su muestra.

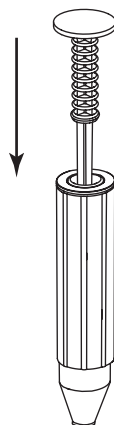
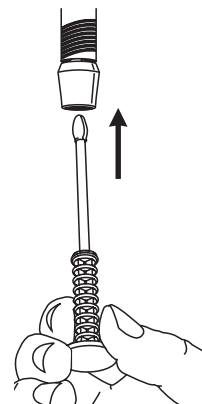

04. Sostenga el muestreador en posición vertical y oprima hasta el fondo para activarlo.

Nota: el muestreador se debe sostener en posición vertical.

05. Mezcle durante dos segundos.

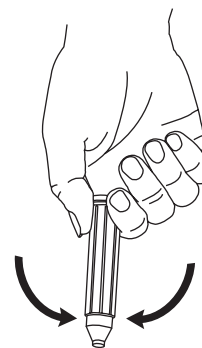
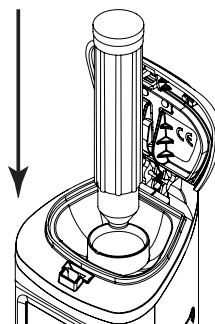

06. Coloque en el instrumento de inmediato.

01. Mantenha o botão central em seu AccuPoint Advanced Next Gen pressionado. Se necessário, insira nome de usuário e senha

02. Selecione a amostragem geral de teste padrão (ao usar um plano de local) ou de teste rápido. Em teste padrão, selecione o local certo a ser testado

03. Amostre seu local “desenhando” um quadrado de 10x10 cm. Executando um movimento vertical e horizontal para frente e para trás, “preencha” o quadrado. É crucial executar uma operação consistente.

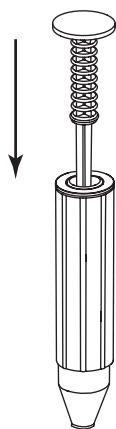
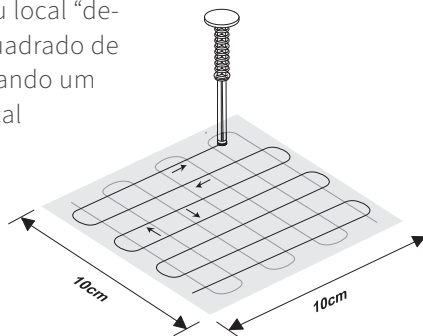

05. Misture delicadamente por 2 segundos.
OBS.: não agite

04. Segure o amostrador na posição vertical e pressione completamente para ativar.
Obs.: é necessário segurar o amostrador na posição vertical.

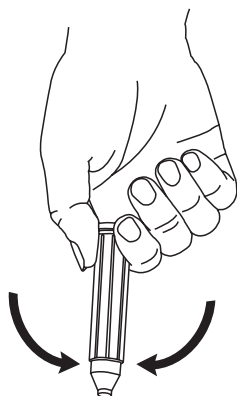

06. Com o instrumento posicionado na posição vertical, pressione o botão de ejetar e insira o amostrador.

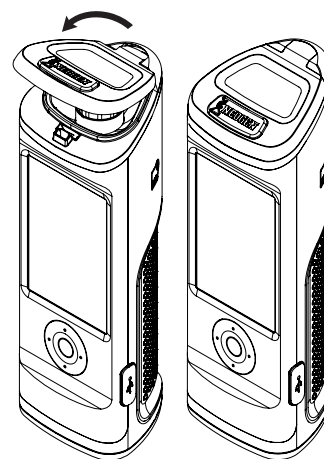
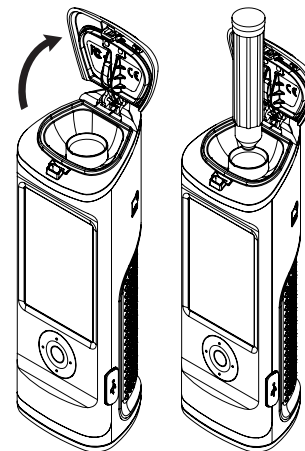

07. Pressione o amostrador até o fim e feche a porta.

Obs.: mantenha o instrumento na posição vertical enquanto a amostra estiver sendo lida.

08. A pontuação em unidades relativas de luz (URL) será exibida juntamente com o símbolo de aprovado, alerta ou reprovado.

09. Na tela de resultados, os usuários têm a opção de adicionar observações para o respectivo resultado, retestar o local ou continuar para o próximo local no plano.

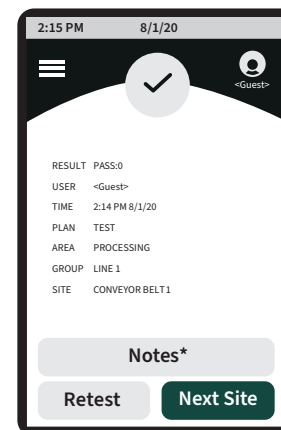

Amostrador de água

01. Ligue o instrumento. Certifique-se de estar na tela principal.

02. Selecione o local correto para o teste. Um ícone de gota d'água na tela indica o uso de um amostrador de água.

03. Colete sua amostra mergulhando o amostrador de água no líquido.

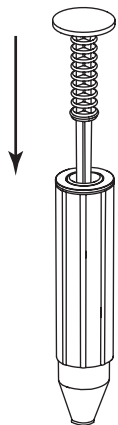
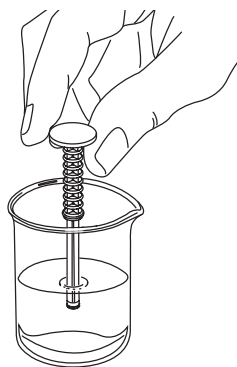

04. Segure o amostrador na posição vertical e pressione completamente para ativar.
Obs.: é necessário segurar o amostrador na posição vertical.

05. Misture por 2 segundos.

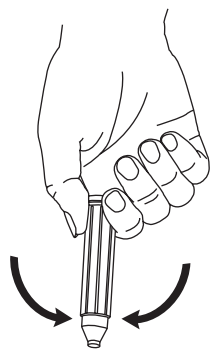
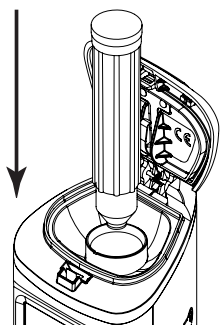

06. Coloque imediatamente no instrumento.

Amostrador de acesso

01. Ligue o instrumento. Certifique-se de estar na tela principal.

02. Selecione o local correto para o teste.

03. Remova o amostrador de acesso e colete sua amostra.

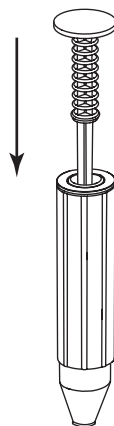
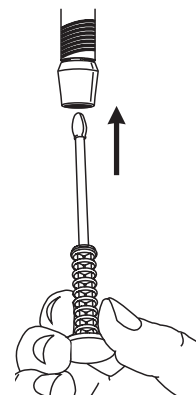

04. Segure o amostrador na posição vertical e pressione completamente para ativar.
Obs.: é necessário segurar o amostrador na posição vertical.

05. Misture por 2 segundos.

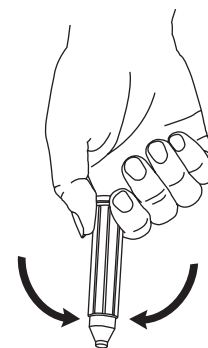
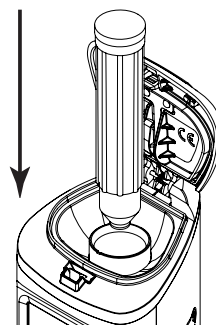

06. Coloque imediatamente no instrumento.



North America
NEOGEN Headquarters
800/234-5333 (USA/Canada)

Brazil
NEOGEN do Brasil
+55 19 3935.3727

Europe, Middle East and Africa
NEOGEN Europe
+ 44 (0) 1292 525 600

China
NEOGEN Bio-Scientific Technology
+86 21 6271 7013

Mexico
NEOGEN Latinoamerica
+52 (55) 5254-8235

India
NEOGEN Food and Animal Security
+91 484 2306598, 2301582